

CENTRAL SCHOOL ADDITION

Space Utilization Computation

Quick overview of current HCS

- Original 1946 building & 1960 addition
- 1964 addition
- 1986 addition

FIRST FLOOR



Existing Ground and First Floor Plan

SECOND FLOOR



Existing Second Floor Plan

School building evaluation criteria

- Design capacity
- Educational Capacity
- Utilization Rate

Per ED 321 – Minimum Standards for
School Building Construction

ED 321 applies to
NEW CONSTRUCTION ONLY

The purpose of Ed 321 is to provide requirements and standards for the construction of any facility to be used for the purpose of providing education to pupils in grades kindergarten through grade 12...

ED 321.01 - Purpose

Therefore, HCS and HMS are
GRANDFATHERED

plus...

State CANNOT force
Hampstead to conform unless
it pays for it, because...

NH Constitution Part 1 – Bill of Rights

[Art.] 28-a. [Mandated Programs.] The state shall not mandate or assign any new, expanded or modified programs or responsibilities to any political subdivision in such a way as to necessitate additional local expenditures by the political subdivision unless such programs or responsibilities are fully funded by the state or unless such programs or responsibilities are approved for funding by a vote of the local legislative body of the political subdivision.

November 28, 1984

Let's test the building as if it were a NEW building...

FIRST TEST: Design Capacity

(d) "Design capacity" means the maximum total number of students intended to be educated in a school building following completion of a construction project.

ED321.02 - Definitions

Criteria:

(a) Elementary schools, 120 square feet/pupil...

ED 321.06 - Maximum Sizes for School Buildings

FIRST TEST:
Design Capacity

73,149 sq. ft. gross building area
÷ 120 sq. ft./pupil =

610 students

SECOND TEST:
Educational Capacity

(e) "Educational capacity of a school building" means the sum of the maximum number of students that can be simultaneously instructed in every EDUCATIONAL SPACE of the building using the MINIMUM SPACE ALLOCATIONS specified in Ed 321.10.

ED 321.02 - Definitions

SECOND TEST: Educational Capacity

- (f) "Educational space" means those parts of a school building to which pupils are assigned for instructional purposes. Educational space includes, but is not limited to, classrooms, laboratories, gymnasiums, and libraries...

ED321.02-Definitions

SECOND TEST: Educational Capacity

- a) ... Space in temporary or relocatable facilities shall not be included in determining the educational capacity of a school building.
- (b) The educational capacity of a school building shall be based upon the PHYSICAL DIMENSIONS OF THE EDUCATIONAL SPACES AND THE SPACE ALLOWANCES IN ED 321.10.

Educational capacity shall NOT be reduced by applying a limit to the number of students in a class BELOW THE MAXIMUM CLASS SIZE FOUND IN ED 306.17 even though local policy may establish lower maximum class sizes.

ED 321.08 – Standards for Educational Space

SECOND TEST: Minimum Space Allocations

- g) A kindergarten classroom shall provide at least 1,000 square feet, including storage, or 50 square feet per child, whichever is greater.
- h) For the elementary and middle schools, a general purpose classroom shall provide a minimum of 900 square feet, including storage, or 36 square feet per child, whichever is greater.

ED 321.10 – Standards for Educational Space

Let's just count classrooms...

...no portables, library, art, gym,
cafeteria, music room, etc...

FIRST FLOOR



Existing Ground and First Floor Plan

SECOND FLOOR

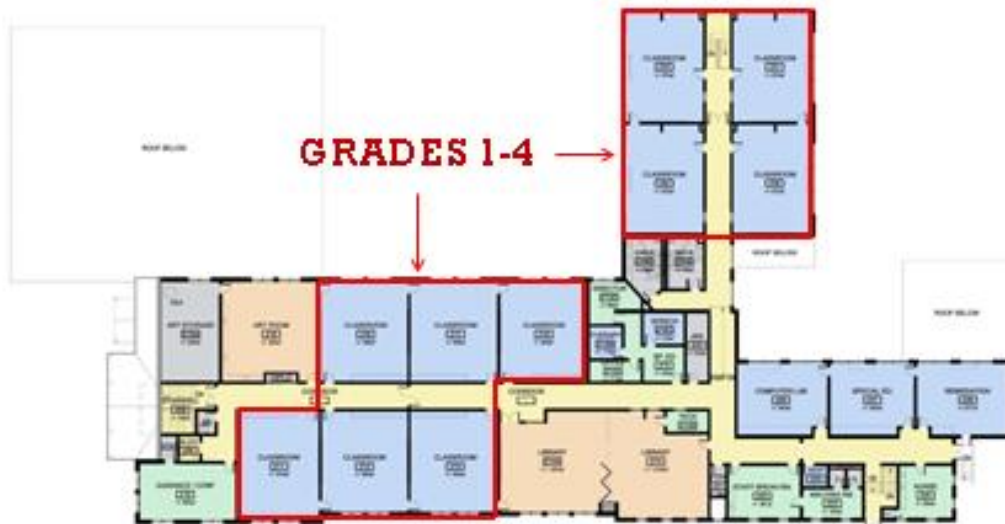

Existing Second Floor Plan

CLASSROOM INVENTORY

Comprehensive Facilities Assessment – September 2010

Appendix
Central School Program

56

Equipment Central School - Equipment - Assembly		Assembly	All Other
Equipment #/Name	Assembly	Assembly	Assembly
1. Administration			
1.1 Principals Office 1100	300 sq. ft.	300 sq. ft.	
1.2 Assistant Principals Office 1100	300 sq. ft.	300 sq. ft.	
1.3 Conference Room 1100	300 sq. ft.	300 sq. ft.	
1.4 Staff Lounge Room 1100	300 sq. ft.	300 sq. ft.	
1.5 Copy Room/Storage	300 sq. ft.	300 sq. ft.	
1.6 Teacher Work Room 1100	700 sq. ft.	700 sq. ft.	
1.7 Teacher Office 1100	300 sq. ft.	300 sq. ft.	
1.8 Student Office/Work Area 1100	300 sq. ft.	300 sq. ft.	
1.9 Office 1100	100 sq. ft.	100 sq. ft.	Office 1100
1.10 Office 1100	300 sq. ft.	300 sq. ft.	
1.11 Assistant Support Room 1100	300 sq. ft.	300 sq. ft.	
1.12 Office 1100	100 sq. ft.	100 sq. ft.	
1.13 Mail Room 1100	300 sq. ft.	300 sq. ft.	
1.14 Restroom 1100	300 sq. ft.	300 sq. ft.	
1.15 Storage Room 1100	300 sq. ft.	300 sq. ft.	
1.16 Test Office 1100	300 sq. ft.	300 sq. ft.	
1.17 Support for Office 1100	300 sq. ft.	300 sq. ft.	
1.18 Office 1100	100 sq. ft.	100 sq. ft.	
1.19 Storage Office 1100	300 sq. ft.	300 sq. ft.	
1.20 Office Office 1100	300 sq. ft.	300 sq. ft.	
1.21 P.E. Office 1100	100 sq. ft.	100 sq. ft.	
1.22 Office 1100	300 sq. ft.	300 sq. ft.	
1.23 Support for Office 1100	300 sq. ft.	300 sq. ft.	
1.24 Office 1100	300 sq. ft.	300 sq. ft.	
1.25 Locker 1100	100 sq. ft.	100 sq. ft.	Locker 1100
1.26 Locker 1100	300 sq. ft.	300 sq. ft.	
1.27 Locker 1100	300 sq. ft.	300 sq. ft.	
2. Instructional			
2.1 Classroom 1100	300 sq. ft.	300 sq. ft.	
2.2 Classroom 1100	300 sq. ft.	300 sq. ft.	
2.3 Classroom 1100	300 sq. ft.	300 sq. ft.	
2.4 Classroom 1100	300 sq. ft.	300 sq. ft.	
2.5 Classroom 1100	300 sq. ft.	300 sq. ft.	
2.6 Classroom 1100	300 sq. ft.	300 sq. ft.	
2.7 Classroom 1100	300 sq. ft.	300 sq. ft.	
2.8 Classroom 1100	300 sq. ft.	300 sq. ft.	
2.9 Classroom 1100	300 sq. ft.	300 sq. ft.	
2.10 Classroom 1100	300 sq. ft.	300 sq. ft.	
2.11 Classroom 1100	300 sq. ft.	300 sq. ft.	
2.12 Classroom 1100	300 sq. ft.	300 sq. ft.	
2.13 Classroom 1100	300 sq. ft.	300 sq. ft.	
2.14 Classroom 1100	300 sq. ft.	300 sq. ft.	
2.15 Classroom 1100	300 sq. ft.	300 sq. ft.	
2.16 Classroom 1100	300 sq. ft.	300 sq. ft.	
2.17 Classroom 1100	300 sq. ft.	300 sq. ft.	
2.18 Classroom 1100	300 sq. ft.	300 sq. ft.	
2.19 Classroom 1100	300 sq. ft.	300 sq. ft.	
2.20 Classroom 1100	300 sq. ft.	300 sq. ft.	
2.21 Classroom 1100	300 sq. ft.	300 sq. ft.	
2.22 Classroom 1100	300 sq. ft.	300 sq. ft.	
2.23 Classroom 1100	300 sq. ft.	300 sq. ft.	
2.24 Classroom 1100	300 sq. ft.	300 sq. ft.	
2.25 Classroom 1100	300 sq. ft.	300 sq. ft.	
2.26 Classroom 1100	300 sq. ft.	300 sq. ft.	
2.27 Classroom 1100	300 sq. ft.	300 sq. ft.	
2.28 Classroom 1100	300 sq. ft.	300 sq. ft.	
2.29 Classroom 1100	300 sq. ft.	300 sq. ft.	
2.30 Classroom 1100	300 sq. ft.	300 sq. ft.	
2.31 Classroom 1100	300 sq. ft.	300 sq. ft.	
2.32 Classroom 1100	300 sq. ft.	300 sq. ft.	
2.33 Classroom 1100	300 sq. ft.	300 sq. ft.	
2.34 Classroom 1100	300 sq. ft.	300 sq. ft.	
2.35 Classroom 1100	300 sq. ft.	300 sq. ft.	
2.36 Classroom 1100	300 sq. ft.	300 sq. ft.	
2.37 Classroom 1100	300 sq. ft.	300 sq. ft.	
2.38 Classroom 1100	300 sq. ft.	300 sq. ft.	
2.39 Classroom 1100	300 sq. ft.	300 sq. ft.	
2.40 Classroom 1100	300 sq. ft.	300 sq. ft.	
2.41 Classroom 1100	300 sq. ft.	300 sq. ft.	
2.42 Classroom 1100	300 sq. ft.	300 sq. ft.	
2.43 Classroom 1100	300 sq. ft.	300 sq. ft.	
2.44 Classroom 1100	300 sq. ft.	300 sq. ft.	
2.45 Classroom 1100	300 sq. ft.	300 sq. ft.	
2.46 Classroom 1100	300 sq. ft.	300 sq. ft.	
2.47 Classroom 1100	300 sq. ft.	300 sq. ft.	
2.48 Classroom 1100	300 sq. ft.	300 sq. ft.	
2.49 Classroom 1100	300 sq. ft.	300 sq. ft.	
2.50 Classroom 1100	300 sq. ft.	300 sq. ft.	
2.51 Classroom 1100	300 sq. ft.	300 sq. ft.	
2.52 Classroom 1100	300 sq. ft.	300 sq. ft.	
2.53 Classroom 1100	300 sq. ft.	300 sq. ft.	
2.54 Classroom 1100	300 sq. ft.	300 sq. ft.	
2.55 Classroom 1100	300 sq. ft.	300 sq. ft.	
2.56 Classroom 1100	300 sq. ft.	300 sq. ft.	
2.57 Classroom 1100	300 sq. ft.	300 sq. ft.	
2.58 Classroom 1100	300 sq. ft.	300 sq. ft.	
2.59 Classroom 1100	300 sq. ft.	300 sq. ft.	
2.60 Classroom 1100	300 sq. ft.	300 sq. ft.	
2.61 Classroom 1100	300 sq. ft.	300 sq. ft.	
2.62 Classroom 1100	300 sq. ft.	300 sq. ft.	
2.63 Classroom 1100	300 sq. ft.	300 sq. ft.	
2.64 Classroom 1100	300 sq. ft.	300 sq. ft.	
2.65 Classroom 1100	300 sq. ft.	300 sq. ft.	
2.66 Classroom 1100	300 sq. ft.	300 sq. ft.	
2.67 Classroom 1100	300 sq. ft.	300 sq. ft.	
2.68 Classroom 1100	300 sq. ft.	300 sq. ft.	
2.69 Classroom 1100	300 sq. ft.	300 sq. ft.	
2.70 Classroom 1100	300 sq. ft.	300 sq. ft.	
2.71 Classroom 1100	300 sq. ft.	300 sq. ft.	
2.72 Classroom 1100	300 sq. ft.	300 sq. ft.	
2.73 Classroom 1100	300 sq. ft.	300 sq. ft.	
2.74 Classroom 1100	300 sq. ft.	300 sq. ft.	
2.75 Classroom 1100	300 sq. ft.	300 sq. ft.	
2.76 Classroom 1100	300 sq. ft.	300 sq. ft.	
2.77 Classroom 1100	300 sq. ft.	300 sq. ft.	
2.78 Classroom 1100	300 sq. ft.	300 sq. ft.	
2.79 Classroom 1100	300 sq. ft.	300 sq. ft.	
2.80 Classroom 1100	300 sq. ft.	300 sq. ft.	
2.81 Classroom 1100	300 sq. ft.	300 sq. ft.	
2.82 Classroom 1100	300 sq. ft.	300 sq. ft.	
2.83 Classroom 1100	300 sq. ft.	300 sq. ft.	
2.84 Classroom 1100	300 sq. ft.	300 sq. ft.	
2.85 Classroom 1100	300 sq. ft.	300 sq. ft.	
2.86 Classroom 1100	300 sq. ft.	300 sq. ft.	
2.87 Classroom 1100	300 sq. ft.	300 sq. ft.	
2.88 Classroom 1100	300 sq. ft.	300 sq. ft.	
2.89 Classroom 1100	300 sq. ft.	300 sq. ft.	
2.90 Classroom 1100	300 sq. ft.	300 sq. ft.	
2.91 Classroom 1100	300 sq. ft.	300 sq. ft.	
2.92 Classroom 1100	300 sq. ft.	300 sq. ft.	
2.93 Classroom 1100	300 sq. ft.	300 sq. ft.	
2.94 Classroom 1100	300 sq. ft.	300 sq. ft.	
2.95 Classroom 1100	300 sq. ft.	300 sq. ft.	
2.96 Classroom 1100	300 sq. ft.	300 sq. ft.	
2.97 Classroom 1100	300 sq. ft.	300 sq. ft.	
2.98 Classroom 1100	300 sq. ft.	300 sq. ft.	
2.99 Classroom 1100	300 sq. ft.	300 sq. ft.	
2.100 Classroom 1100	300 sq. ft.	300 sq. ft.	

PRE-KINDERGARTEN

KINDERGARTEN

PORTABLES

GRADES 1-4

SECOND TEST:

Kindergarten Educational Space

PRE -K	(2)	1,560 sq. ft.
KINDERGARTEN	(4)	<u>3,386 sq. ft.</u>
Subtotal	(6)	4,946 sq. ft.
		÷ 50 sq. ft./pupil

CAPACITY = 99 pupils

SECOND TEST:
Grades 1-4 Educational Space

Grades 1-4 (17) 15,162 sq. ft.

÷ 36 sq. ft./pupil

CAPACITY = 421 pupils

SECOND TEST:
Classroom Educational Capacity
(in full time pupils)

PRE-K/Kindergarten capacity 99 pupils

Grades 1-4 capacity 421 pupils

HCS CAPACITY= 520 pupils

That's classrooms ONLY.

Compute excluded educational space:

▪ Music room	690 sq. ft.
▪ Art Room	960 sq. ft.
▪ Gym	3,010 sq. ft.
▪ Chorus room	945 sq. ft.
▪ Computer lab	803 sq. ft.
▪ Library	<u>2,055 sq. ft.</u>

Additional 8,463 sq. ft.

Excluded space capacity
(in full time pupils)

8,463 sq.ft. ÷ 36 sq.ft/pupil = 235 pupils

PLUS

Previous classroom capacity = 520 pupils

TOTAL HCS CAPACITY= 755 pupils

THIRD TEST: Utilization Rate

- (r) "Utilization rate" means the extent to which school buildings are used by comparing actual student enrollment to the educational capacity of the school expressed in a percentage figure.

A 100 percent utilization rate means that every seat in every educational space is occupied for the majority of time throughout the school day.

ED321.02 - Definitions

THIRD TEST: Utilization Rate Calculation

The utilization rate of a school building shall be calculated by dividing the actual enrollment by the educational capacity and expressing the figure as a percentage.

A 100 percent utilization rate shall not be required.

Ed 321.09 Calculating Utilization Rate.

THIRD TEST:
Utilization Rate Calculation

$$\frac{2015-2016 \text{ Actual Enrollment}}{\text{Educational Capacity}} = \text{Utilization Rate}$$

$$\frac{466}{755} = 61.7\%$$

CONCLUSION

2015-2016 Pre-K-4 enrollment = 466 pupils

Design Capacity = 610 pupils

Educational Capacity = 755 pupils

Utilization Rate (current) = 61.7%

therefore...

CENTRAL SCHOOL ADDITION
IS NOT NEEDED

There is sufficient, existing
classroom space
—excluding portables—
to accommodate projected
NESDEC Enrollments through 2023
and beyond